

ADVERTISEMENT FOR BIDS

**Tennis & Pickle Ball Courtside Improvements
Arcadia, Wisconsin**

Notice is hereby given that Bids will be received by the City of Arcadia until 12:00 p.m. on Thursday, February 29, 2024 for the furnishing of all labor and material for the construction of the following items:

Bid Package	Item
1	Excavation – Excavate areas for the sidewalk, lay 6” of limestone base, and grade the surrounding surface for proper water drainage away from the sidewalk
2	Concrete – pour concrete per the drawing specifications and install (5) granite plaques
3	Canopy Structures – Engineering, Fabrication, and Installation of (2) Canopies

Bidders may bid on one or more packages. Bidder are responsible for providing all components of package(s) on which they are awarded the bid. Bids should be mailed or dropped off at City Hall, 945 S. Dettloff Drive, Arcadia, WI 54612.

The bid opening will be conducted at City Hall on Thursday, February 29, 2024, at 12:00 p.m., at which time they will be publicly opened and read aloud. Consideration of bid award will be made at the city council meeting on Wednesday, March 6, 2024 at 5:30 p.m.

The Bidding Documents may be obtained for no cost at 945 South Dettloff Drive, Arcadia, WI 54612, online at www.cityofarcadiawi.com or by calling the City of Arcadia clerk at (608) 323-3359. If bidders have specific questions regarding the project, please contact Matt Goulette at 608-630-4601.

All bids shall remain subject to acceptance by the City for a period of 60 days from the opening of bids.

City of Arcadia reserves the right to reject any and all bids, to waive irregularities and informalities therein, and to award the Contract in the best interests of the City.

Angela Berg, Clerk-Treasurer
City of Arcadia
945 S. Dettloff Drive
Arcadia, WI 54612

Published: February 14, 2024 and February 21, 2024

Contractor Bid Sheet



Contractor: _____

Date: _____

Project: Memorial Park - Arcadia, WI
 Tennis & Pickleball Courts

Item	Item Description	Quantity	Unit	Unit Price	Total
1	Excavation	163	cy		\$ -
2	Concrete Demo (6" Thick)	36	sf		\$ -
3	Gravel	160	tons		\$ -
TOTAL					\$ -

Contractor Bid Sheet



Contractor: _____

Date: _____

Project: Memorial Park - Arcadia, WI
 Tennis & Pickleball Courts

Item	Item Description	Quantity	Unit	Unit Price	Total
1	Concrete	86	cy		\$ -
TOTAL					\$ -

Contractor Bid Sheet



Contractor: _____

Date: _____

Project: **Memorial Park - Arcadia, WI**
Tennis & Pickleball Courts

Item	Item Description	Quantity	Unit	Unit Price	Total
1	Canopy Structure - Engineering, Fabrication, and Install	2	each		\$ -
TOTAL					\$ -

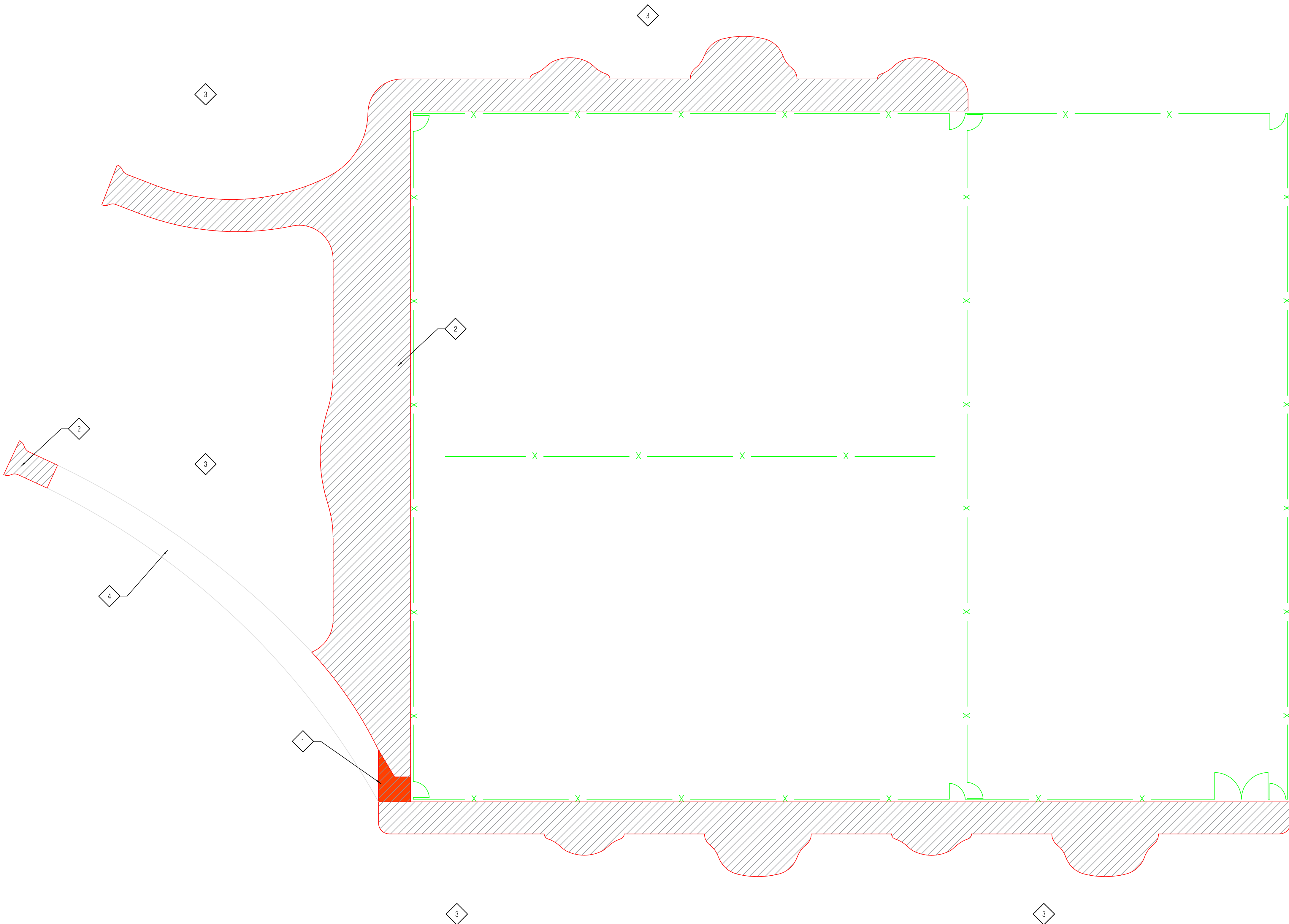

DEMO & EXCAVATION NOTES	
1	DEMO EXISTING 6" CONCRETE (36 SF) AND HAUL OFF-SITE.
2	EXCAVATE HATCHED AREA (163 CY) PER CONCRETE DETAILS.
3	GRADE SURROUNDING SURFACES TO ENSURE WATER DRAINS AWAY FROM SIDEWALK AFTER CONCRETE IS POURED. EXTRA FILL TO BE HAULED OFF-SITE.
4	EXISTING SIDEWALK TO REMAIN

Seal / Stamp:

APPROVAL IS ONLY FOR CONFORMANCE WITH THE DESIGN CONCEPT OF THE PROJECT AND COMPLIANCE WITH THE INFORMATION GIVEN IN THE CONTRACT DOCUMENTS. THE CONTRACTOR IS RESPONSIBLE FOR DIMENSIONS TO BE CONFIRMED AND CORRELATED AT THE JOB SITE. FOR INFORMATION THAT PERTAINS SOLELY TO THE FABRICATION PROCESSES OR TO TECHNIQUES OF CONSTRUCTION AND FOR COORDINATION OF THE WORK OF ALL TRADES.

Owner / Owner Representative _____ Date _____

Contractor _____ Date _____

Drawing Status:

Bid Set

Architect / Engineer:

No.	Description	Date

Owner:

W26051 WI-95, Arcadia, WI 54612 PH. (608) 323-3470

Project Name:

Memorial Park - Arcadia, WI
Tennis & Pickleball Sidewalk/Canopy

Project Address:

551 Memorial Park Dr, Arcadia, WI 54612

Sheet Name:

DEMO & EXCAVATION PLAN

Designer:

RON WANEK

Drawing Number:

TBD

Checker:

ALEX LINDBERG

Sheet Number:

C-100

Drafter:

MATT GOULETTE

Scale:

AS INDICATED

Date:

02/09/24

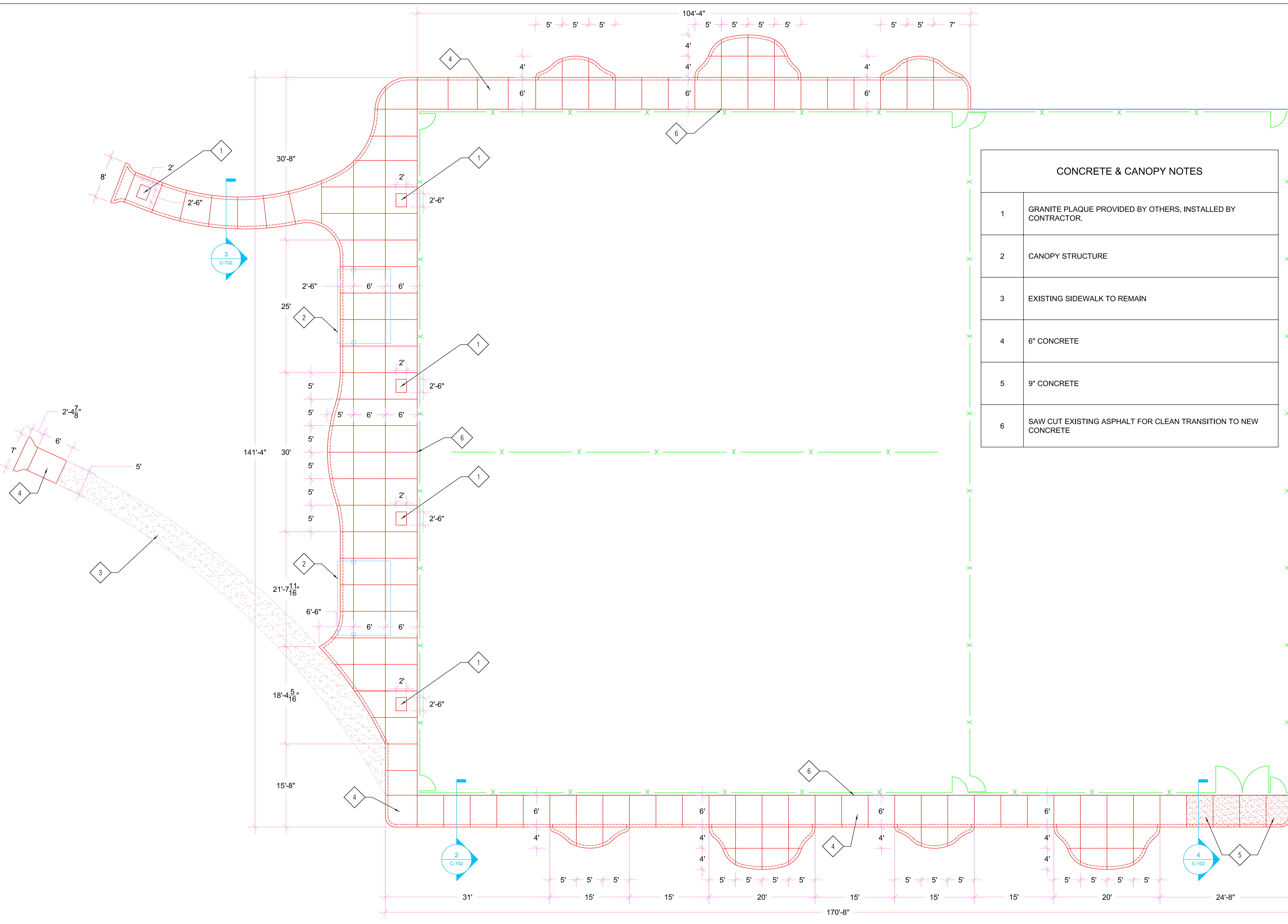

1	GRANITE PLAQUE PROVIDED BY OTHERS, INSTALLED BY CONTRACTOR.
2	CANOPY STRUCTURE
3	EXISTING SIDEWALK TO REMAIN
4	6" CONCRETE
5	9" CONCRETE
6	SAW CUT EXISTING ASPHALT FOR CLEAN TRANSITION TO NEW CONCRETE

Seal / Stamp:

APPROVAL IS ONLY FOR CONFORMANCE WITH THE DESIGN CONCEPT OF THE PROJECT AND COMPLIANCE WITH THE INFORMATION GIVEN IN THE CONTRACT DOCUMENTS. THE CONTRACTOR IS RESPONSIBLE FOR DIMENSIONS TO BE CONFIRMED AND CORRELATED AT THE JOB SITE. FOR INFORMATION THAT PERTAINS SOLELY TO THE FABRICATION PROCESSES OR TO TECHNIQUES OF CONSTRUCTION AND FOR COORDINATION OF THE WORK OF ALL TRADES.

Owner / Owner Representative _____ Date _____

Contractor _____ Date _____

Drawing Status:

Bid Set

Architect / Engineer: _____

No.	Description	Date

Owner:

W26051 WI-95, Arcadia, WI 54612 PH. (608) 323-3470

Project Name:

Memorial Park - Arcadia, WI
 Tennis & Pickleball Sidewalk/Canopy

Project Address:

551 Memorial Park Dr, Arcadia, WI 54612

Sheet Name:
CONCRETE PLAN

Designer: **RON WANEK** Drawing Number: **TBD**

Checker: **ALEX LINDBERG** Sheet Number: _____

Drafter: **MATT GOULETTE**

Scale: **AS INDICATED**

Date: **02/09/24**

C-101

NOTE: CANOPY STRUCTURE CONCEPT MUST BE REVIEWED AND APPROVED BY A STRUCTURAL ENGINEER. ALL STRUCTURAL STEEL TO BE POWDER COATED. METAL ROOFING TO BE INSTALLED ON TOP AND UNDER THE ROOF STRUCTURE TO AVOID BIRD NESTING. COLOR OF POWDER COATING AND METAL ROOF TO BE DETERMINED BY OTHERS.

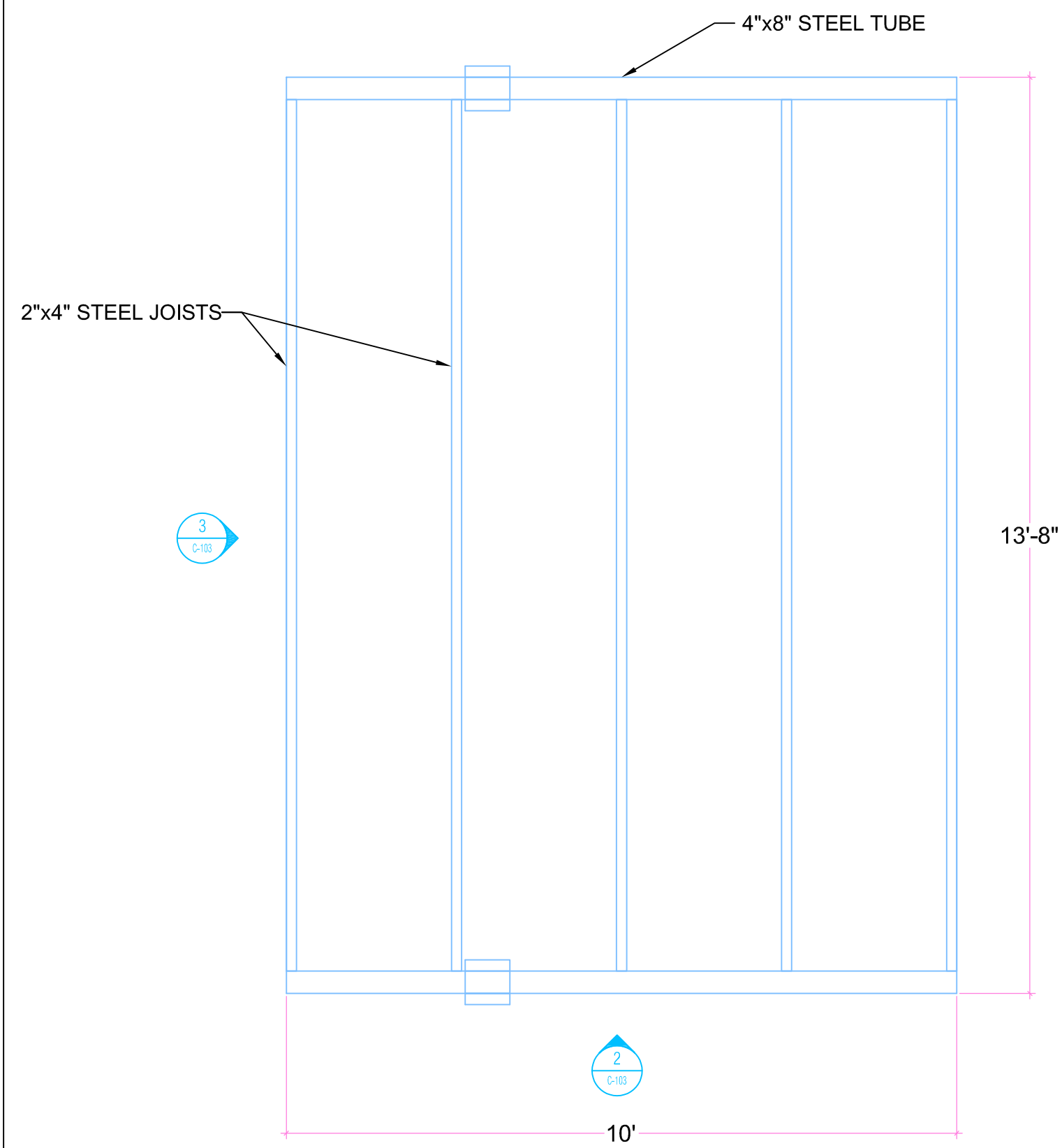

1 PLAN VIEW - CANOPY ROOF STRUCTURE
1/8\"/>

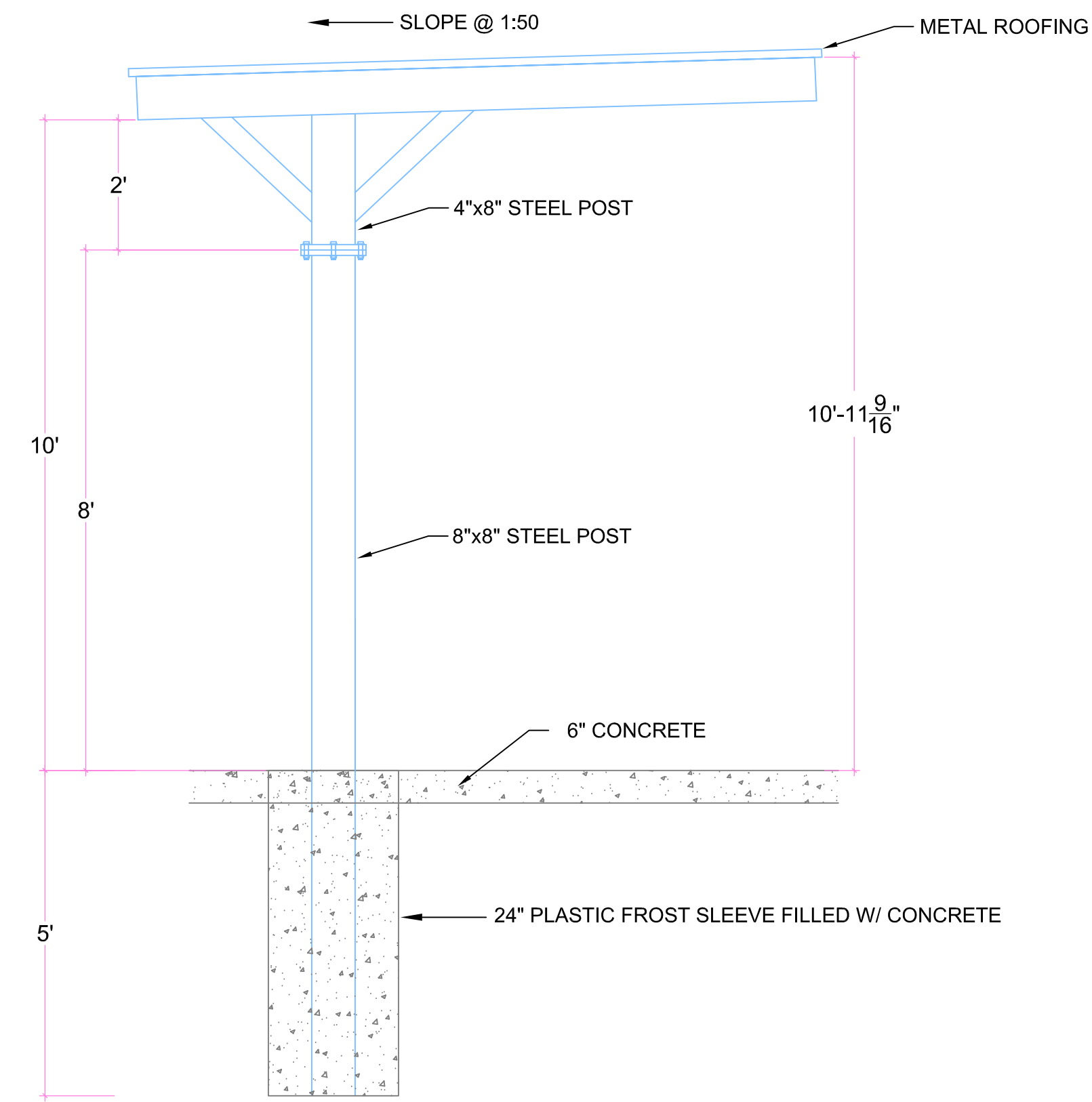

2 RIGHT VIEW - CANOPY STRUCTURE
1/8\"/>

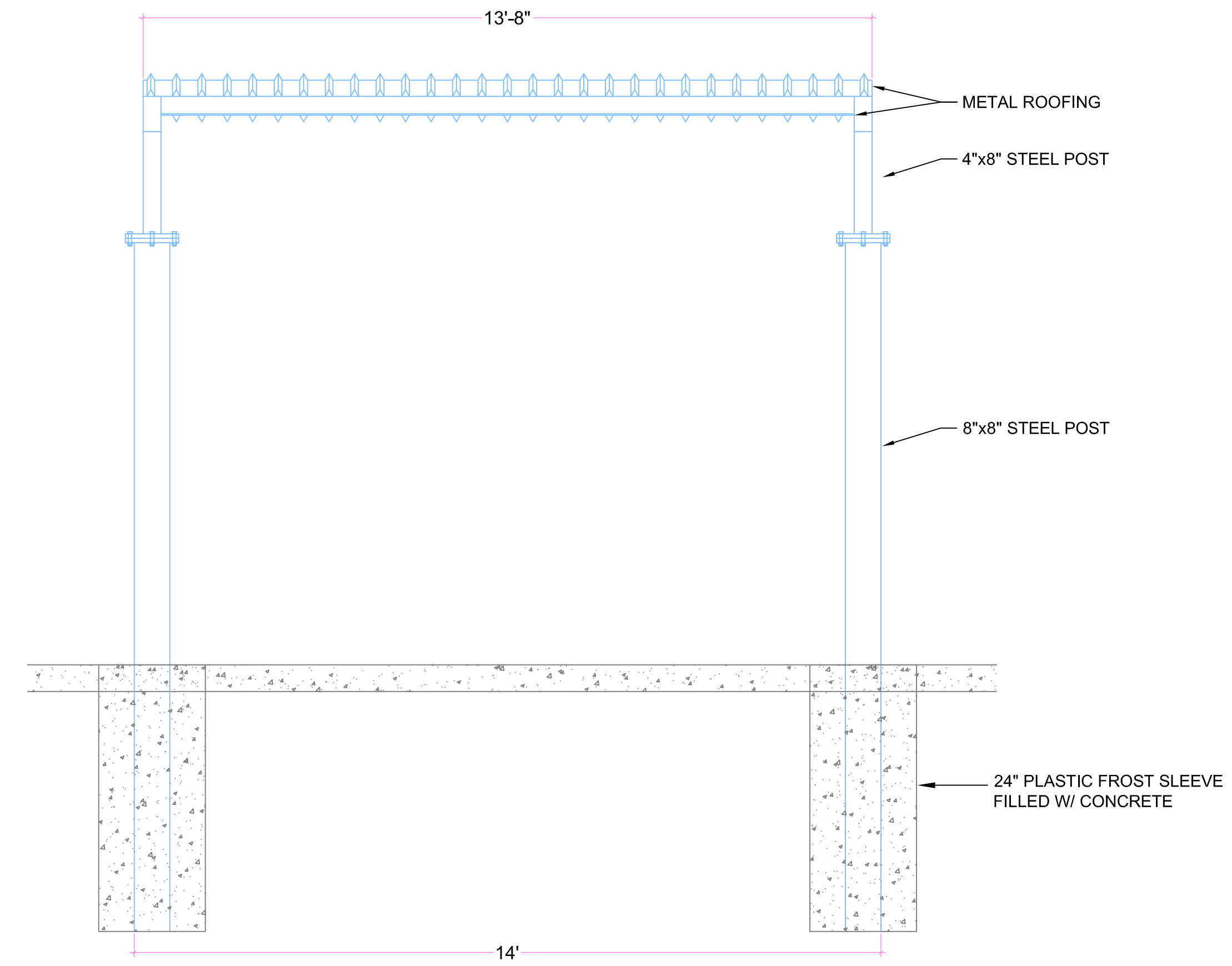

3 REAR VIEW - CANOPY STRUCTURE
1/8\"/>

Seal / Stamp:

APPROVAL IS ONLY FOR CONFORMANCE WITH THE DESIGN CONCEPT OF THE PROJECT AND COMPLIANCE WITH THE INFORMATION GIVEN IN THE CONTRACT DOCUMENTS. THE CONTRACTOR IS RESPONSIBLE FOR DIMENSIONS TO BE CONFIRMED AND CORRELATED AT THE JOB SITE. FOR INFORMATION THAT PERTAINS SOLELY TO THE FABRICATION PROCESSES OR TO TECHNIQUES OF CONSTRUCTION AND FOR COORDINATION OF THE WORK OF ALL TRADES.

Owner / Owner Representative _____ Date _____

Contractor _____ Date _____

Drawing Status:

Bid Set

Architect / Engineer:

No.	Description	Date

Owner:

W26051 WI-95, Arcadia, WI 54612 PH: (608) 323-3470

Project Name:
 Memorial Park - Arcadia, WI
 Tennis & Pickleball Sidewalk/Canopy

Project Address:
 551 Memorial Park Dr, Arcadia, WI 54612

Sheet Name:
 CANOPY STRUCTURE

Designer: _____ Drawing Number: TBD
 ALEX LINDBERG
 Checker: _____ Sheet Number:
 ALEX LINDBERG
 Drafter: MATT GOULETTE
 Scale: AS INDICATED
 Date: 02/09/24

C-103